

OPERATING INSTRUCTIONS

CS EX EX-Camerastation

CS-EX-W-XXXX-JB-XXX-XX-P

Contents

1. ABOUT THESE INSTRUCTIONS	3
1.1 Symbols and guidance signs in these instructions	3
1.2 Who are these instructions for?	3
2. SAFETY	3
2.1 Operating conditions	3
2.2 Safety instructions	4
2.3 Notes for the use in EX areas	4
3. AN OVERVIEW OF THE UNIT	5
3.1 Technical data	5
3.2 Applications	6
4. INSTALLATION	6
4.1 Mounting	6
4.2 Electrical connection	7
4.3 Connection of the exterior equipotential bonding	7
4.4 Set up and operation	7
5. MAINTENANCE	8
6. REPAIR / RECONDITIONING	8
7. DISPOSAL	8
8. ACCESSORIES	8
9. SPARE PARTS	9
10. EXAMINATION CERTIFICATE	10
11. DECLARATION OF CONFORMITY	11

1. About these instructions

1.1 Symbols and guidance signs in these instructions



Danger! There is a risk to life and limb if the warning is not followed.

- **Enumerations** begin with an enumeration line.



Information from the manufacturer begins with an i.

1.2 Who are these instructions for?

When working in hazardous areas the safety of personnel and plant depends on complying with all relevant safety regulations. Fitting and maintenance staff working on such installations therefore have a particular responsibility. They require precise knowledge of the applicable rules and regulations.

These instructions give a brief summary of the most important safety measures. They supplement the corresponding regulations that the responsible staff must study.

2. Safety

The following safety instructions have to be strictly followed! Otherwise you put yourself and others in danger.

2.1 Operating conditions



Commissioning! Before putting the EX Camerastation into operation, make sure that:

- The EX Camerastation is not damaged
- The seals are attached
- The EX Camerastation is firmly mounted
- The connection cable is not tangled
- That the conditions and information in these instructions and the parameters on the type plate are followed

2.2 Safety instructions



Use the EX Camerastation it only for its approved purpose. Ensure that the maximum temperature range (T_a) is not exceeded during installation and operation.



Incorrect or improper use or non-compliance with the information in these operating instructions invalidates its warranty.



Conversions and modifications of EX Camerastation that negatively affect protection against explosion are not permitted. The cable entry, the cables and the plug screws may also not be changed.



The EX Camerastation unit may be operated only in an undamaged and clean condition.



The operating company bears the sole responsibility with regard to the use of this EX Camerastation for its intended purpose, in reference to the boundary conditions existing in the plant.

2.3 Notes for the use in EX areas

The pan/tilt unit conforms to the following regulations and standards:

- Directive 94/9/EC
- IEC 60079-0:2011
- IEC 60079-1:2007

The EX Camerastation type CS EX is approved for use in Zone 1 and 2 explosive areas.

We will provide a copy of the EC Type-Test Certificate with the relevant annex on request.



Screws for fastening the pressure-resistant housing may only be replaced by original screws from the manufacturer (strength A2-70).



Connection cables must be

- Laid and connected in accordance with the applicable installation regulations.
- Either be connected outside the potentially explosive atmosphere or inside the potentially explosive atmosphere in an enclosure with a suitable type of explosion protection.
- Be permanently installed on site.
- Have a strain relief.

3. An overview of the unit

3.1 Technical data

Dimensional sketch:

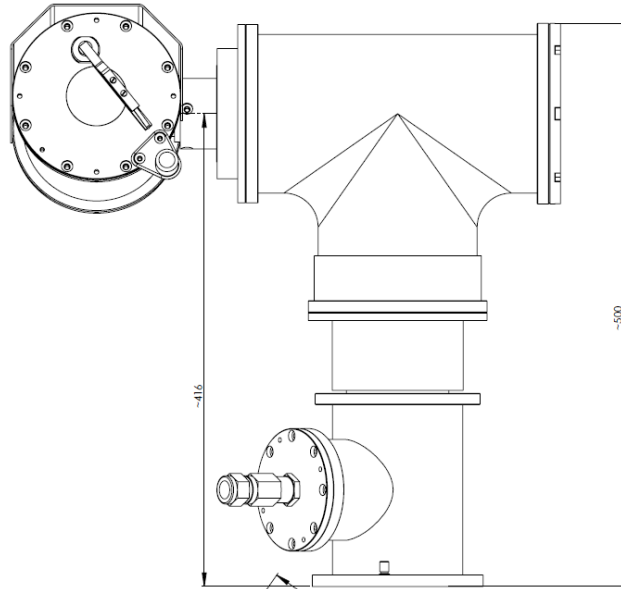



Figure 1: dimensional sketch of the EX Camerastation

Type key:

WISKA® make power smile		Type discription for WISKA EX CameraStation	
CS	EX	W - XXXX -	JB - XXX - XX - P - H
			Mounting H = up side down none = standing
			P = Preset
			Communication IP = IP AN = Analog PO = POE LW = LWL
			Power 230 = 230VAC 24 = 24VDC
			JB= Junction Box included
			Kind of camera modul 2400 = Sony FCB-EX2400P M2AF = Ganz Kameramodul Typ M2AF 2030 = SDZ2030
			Option Wiper W = Wiper
			option for EXplosionproof housing
			Type name Camera Station

Power Supply :	230VAC/ 24VDC
Explosion protection:	ATEX:  II 2G Ex d IIC T6 Gb IECEX: Ex d IIC T6 Gb
Ambient temperature:	-30°C ≤ Ta ≤ +55°C
Protection rating in accordance with IEC 60529:	IP 66/68 (0.2 bar, 30 min)
Test certificate:	TÜV 15 ATEX 7677X IECEX TUR 15.0009X
Housing material:	Stainless steel 1.4571 (AISI316Ti / SUS316TiTp), stainless steel 1.4301 (AISI304 /V2a) powder-coated
Weight:	CS EX →40kg



Please consult the manufacturer if operating conditions are non-standard.

3.2 Applications



The EX Camerastation is used to execute panning and tilting movements for additionally mounted camera systems in Zone 1 and 2 explosive areas

4. Installation



Transport and storage are only permitted in the original packaging.

4.1 Mounting

Direct mounting

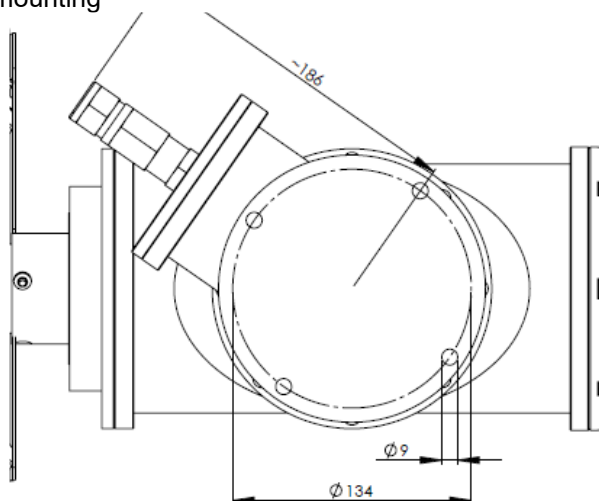

Figure 2: direct mounting connecting dimensions

4.2 Electrical connection

The EX Camerastation is supplied ready to connect. It is possible that the manufacturer delivers the EX Camerastation with defined cable length and cable gland. The customer can take the camera station in operation then directly, without further opening the connection room. If the EX-camerastation does not come with fixed cable and KLE, the customer select a certified separately KLE and place the supplied cable in the connection room, by taking into account the currently valid regulations. Connection takes place on site and is to be done by appropriately trained technical personnel. The connecting thread has thread of type M20x1.5for connecting the basic EX Camerastation with an approved cable gland in the default.The trained technical personnel must be observing the installation instructions for the cable gland. The connection is made on the intended terminal strip according to the wiring diagram



Connection cables must be

- Laid and connected in accordance with the applicable installation regulations.
- Either be connected outside the potentially explosive atmosphere or inside the potentially explosive atmosphere in an enclosure with a suitable type of explosion protection.
- Be permanently installed on site.
- Have a strain relief.

4.3 Connection of the exterior equipotential bonding

An exterior equipotential bond must be connected to the EX Camerastation. The connection point on the EX Camerastation is located on the connection base of the EX Camerastation and is marked accordingly.

The cable which is to be used must have a cross-section of 4 mm² and has a size 6 - 6 crimp-type socket in accordance with DIN 46237 for connection to the EX Camerastation.

For secure installation of the crimp-type socket the following tool should be used:

- No. 10 6000 crimping pliers with crimping profile inserts no. 10 6010 from CIMCO (www.cimco.de)
- or
- crimping tool no. 97 21 215 from KNIPEX ((www.knipex.de))

4.4 Set up and operation

Observe the following during installation and operation:

- National safety regulations
- National accident prevention regulations
- National fitting and installation regulations (e.g. IEC 60079-14)
- Generally recognized technical regulations
- Safety guidelines in these operating instructions
- Characteristic values on the EX Camerastations

Any damage can invalidate the explosion protection.

5. Maintenance



Observe the relevant national regulations for the country of use!



The EX Camerastation may not be opened even for maintenance purposes. Maintenance is possible only by trained personnel from WISKA Hoppmann & Mulsow.

The following points shall be checked during maintenance:

- Observation of the approved temperatures
(according to IEC 60079-0 and the instructions on the EX Camerastation type plate)
- Cracks in the cable gland
- Damage to the gaskets
- Screw connections are properly seated

6. Repair / Reconditioning

Repair / reconditioning work may only be undertaken using WISKA original spare parts.

Repairs which affect the explosion protection may only be carried out by WISKA in compliance with national mandatory legislation and regulations.



Conversions or modifications of the EX Camerastation are not permitted.



The screws used consist of the material A2 with the strength class 70. These minimum values must be retained in case of exchange/replacement.

7. Disposal

Observe the national regulations for refuse disposal.



We are pleased to answer any special questions you may have.

8. Accessories



Only use original WISKA accessories.



When using third-party products, a direct connection through the EX Camerastation is forbidden.

9. Spare parts



Only use original WISKA spare parts.





Please do not hesitate to contact us if you require any further information or advice regarding spare parts.

10. Examination certificate

IECEx Certificate of Conformity			
INTERNATIONAL ELECTROTECHNICAL COMMISSION IEC Certification Scheme for Explosive Atmospheres			
for rules and details of the IECEx Scheme visit www.iecex.com			
Certificate No.:	IECEx TUR 15.0008X	Issue No. 1	<u>Certificate history</u>
Status:	Current	Issue No. 1 (2017-10-26)	Issue No. 0 (2015-05-26)
Date of Issue:	2017-10-26	Page 1 of 5	
Applicant:	WISKA Hoppmann GmbH Kisdorfer Weg 28 24568 Kaltenkirchen Germany		
Equipment:	Ex-CameraStation type CS-EXWxxxx/JB/xxx/xx/PI/H		
Optional accessory:			
Type of Protection:	Flameproof enclosure		
Marking:	Ex db IIC T6 Gb 30°C ≤ Ta ≤ +50°C IP68, IP68 (0.2 bar, 30 min) acc. IEC 60529		
Approved for issue on behalf of the IECEx Certification Body:	Dipl.-Ing. Andreas Maschke		
Position:	Deputy Head of Certification Body		
Signature: (for printed version)			
Date:	2017-10-26		
1. This certificate and schedule may only be reproduced in full. 2. This certificate is not transferable and remains the property of the issuing body. 3. The Status and authenticity of this certificate may be verified by visiting the Official IECEx Website.			
Certificate issued by:	TÜV Rheinland Industrie Service GmbH Am Grauen Stein 51105 Cologne Germany		

(1) EU-TYPE EXAMINATION CERTIFICATE		
(2) Equipment and Protective Systems intended for use in Potentially Explosive Atmosphere - Directive 2014/34/EU		
(3) EU-Type Examination Certificate Number		
TÜV 15 ATEX 7677 X		Issue: 01
(4) Equipment:	Ex-CameraStation, type CS-EXW/xxxx/JB/xxx/xx/PI/H	
(5) Manufacturer:	WISKA Hoppmann GmbH	
(6) Address:	Kisdorfer Weg 28 24568 Kaltenkirchen, Germany	
(7) This product and any acceptable variation thereto are specified in the schedule to this certificate and the documents therein referred to.		
(8) The TÜV Rheinland Zertifizierungsstelle für Explosionsschutz von TÜV Rheinland Industrie Service GmbH, Notified Body No. 0035 in accordance with Article 21 of the Council Directive 2014/34/EU of 26 th February 2014, certifies this product which has been found to comply with the Essential Health and Safety Requirements relating to the design and construction of equipment and protective systems intended for use in potentially explosive atmosphere, given in Annex II to the Directive.		
The examination and test results are recorded in the confidential report 557/Ex877.01/15		
(9) Compliance with the Essential Health and Safety Requirements, with the exception of those listed in the schedule of this certificate, has been assessed by reference to:		
EN 60079-0: 2012+A11 2013 EN 60079-1: 2014		
(10) If the sign "X" is placed after the certificate number, it indicates that the equipment is subject to special conditions for safe use specified in the schedule to this certificate.		
(11) This EU-Type Examination Certificate relates only to the design and specification for construction of the equipment or protective system. It does not cover the process for actual manufacture or supply of the equipment or protective system, for which further requirements of the directive are applicable.		
(12) The marking of the equipment shall include the following:		
II 2 G Ex db IIC T6 Gb		
TÜV Rheinland Zertifizierungsstelle für Explosionsschutz		Cologne, 2017-10-26
 Dipl.-Ing. Andreas Maschke		
<small> This EU-Type Examination Certificate without signature and stamp shall not be valid. The EU-Type Examination Certificate may be circulated only without alteration. Extracts or alterations are subject to approval by the TÜV Rheinland Industrie Service GmbH TÜV Rheinland Group, Am Grauen Stein 51105 Köln. Tel. +49 (0) 221 806-0 Fax. +49 (0) 221 806 114 </small>		
www.tuv.com		

11. Declaration of conformity

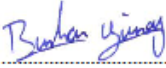
CE	EU DECLARATION OF CONFORMITY	CE
<p>WISKA Hoppmann GmbH Kisdorfer Weg 28 24568 Kaltenkirchen Germany</p>		 WISKA make power smile
declares that the following product:		
Product designation:	Camerastation	
Type designation:	CS-EX/W/xxxx/JB/xxx/xx/PH	
Approval number:	TÜV 15 ATEX 7677 X	
Description:	Camerastation for CCTV systems	
corresponds to all the relevant provisions of the directives listed below and valid harmonized and / or international and national standards - including all applicable changes at this time of issuing this document.		
Directive	Standard	
2014/35/EU Electrical apparatus (Low voltage directive)	Not applicable acc. to article 1	
2014/34/EU Equipment and protective systems intended for use in potentially explosive atmospheres (ATEX)	EN 60079-0:2011 (IEC 60079-0:2011) EN 60079-1:2007 (IEC 60079-1:2007-04)	
2014/30/EU Electromagnetic compatibility (EMC directive)	EN 50130-4:1995 +A1:1998 +A2:2003 EN 61000-4-2:1995 +A1:1998 +A2:2001 EN 61000-4-3:2006 +A1:2008 EN 61000-4-4:2004 EN 61000-4-5:2006 EN 61000-4-6:2007	
2006/42/EC Machinery (machinery directive)	Not applicable acc. to article 1, para. 2f	
Product details		
Marking:	 II 2 G Ex d IIC T6 Gb  Ex d IIC T6 Gb	
Ambient temperature range:	-30°C ... +55°C	
Name and address of the person who is authorized to compile the technical documentation together:	WISKA Hoppmann GmbH Kisdorfer Weg 28 24568 Kaltenkirchen / Germany	
Kaltenkirchen, 2017-02-27	 Head of Development CCTV	
CE		

WISKA Hoppmann GmbH

Kisdorfer Weg 28
24568 Kaltenkirchen
Germany

☎ +49 (0) 4191/508-0

☎ +49 (0) 4191/508-129

contact@wiska.de

www.wiska.com

30102634-02

TRANSLATION OF THE ORIGINAL
Subject to alteration